



DEPARTMENT OF THE ARMY
U.S. ARMY CORPS OF ENGINEERS, NEW YORK DISTRICT
JACOB K. JAVITS FEDERAL BUILDING
26 FEDERAL PLAZA
NEW YORK NEW YORK 10278-0090

SEP 06 2019

REGULATORY BRANCH

SUBJECT: Department of the Army Permit Application File Number NAN-2019-01013-EMI by New Jersey Department of Transportation for Bridge Scour Installation at the NJ Route 18 Bridge over the Raritan River in the City of New Brunswick, Middlesex County, New Jersey

1. PERMITTEE:

New Jersey Department of Transportation
Attn: Brendan K. Brock
951 Parkway Avenue
Ewing, New Jersey 08625

2. On August 15, 2019 the New York District of the U.S. Army Corps of Engineers received a request for Department of the Army authorization to install scour countermeasures at Piers 1-3 and along the south retaining wall of the Route 18 Bridge over the Raritan River. Approximately 2,001 cubic yards of pre-cast concrete armoring will be installed below the plane of Spring High Water over an area of approximately 0.62 acres. A turbidity curtain will be used. The project is located in the Raritan River at the Route 18 Bridge (NJDOT Structure #1237.155) in the City of New Brunswick, Middlesex County, New Jersey.

3. The specific applicant-provided details are as shown on the attached permit drawings titled "Route 18 (Metlars Lane) Over Raritan River Bridge Scour Countermeasures" dated July 2019, prepared by Malick & Scherer, P.C.

4. This determination covers only the work described in the submitted material. Any major changes in the project may require additional authorizations from the New York District of the U.S. Army Corps of Engineers.

5. Based on the information submitted to this office and accomplishment of any required notification in accordance with the applicable federal requirements, our review of the subject work indicates that an individual Department of the Army permit is not required. It appears that the activities within the jurisdiction of this office could be accomplished under Department of the Army Nationwide General Permit Number 3 MAINTENANCE and Number 15 U.S. COAST GUARD APPROVED BRIDGES in accordance with Section 404 of the Clean Water Act (33 U.S.C. 1344). The nationwide permits are prescribed at Reissuance of Nationwide Permits in the Federal Register dated January 6, 2017 (82 FR 1860). The subject work may be performed without further authorization from this office provided it complies with Sections A through D Number 3 MAINTENANCE and Number 15 U.S. COAST GUARD APPROVED BRIDGES; New York District regional conditions; the

SUBJECT: Department of the Army Permit Application File Number NAN-2019-01013-EMI by New Jersey Department of Transportation for Bridge Scour Installation at the NJ Route 18 Bridge over the Raritan River in the City of New Brunswick, Middlesex County, New Jersey

- 2 -

following work-specific Special Conditions listed below; and any applicable regional conditions added by the State of New Jersey.

6. Other than the work-specific Special Conditions listed below, the 2017 nationwide general permits in the State of New Jersey, including their final regional conditions, water quality certifications, and coastal zone concurrence statements are available at:

<https://www.nap.usace.army.mil/Portals/39/docs/regulatory/publicnotices/2017%20Nationwide%20Permit%20General%20Conditions.pdf>

https://www.nap.usace.army.mil/Portals/39/docs/regulatory/publicnotices/2017_NJ_Reg_Cond_Final.pdf

If you require a specific paper copy, please contact our Regulator-of-the-Day at 917-790-8511 to request one be mailed to you. Please be sure to have the above eighteen-character file number readily available when you call.

7. Work-specific Special Conditions:

(A) The permittee understands and agrees that, if future operations by the United States require the removal, relocation, or other alteration, of the structure or work herein authorized, or if, in the opinion of the Secretary of the Army or his authorized representative, said structure or work shall cause unreasonable obstruction to the free navigation of the navigable waters, the permittee will be required, upon due notice from the Corps of Engineers, to remove, relocate, or alter the structural work or obstructions caused thereby, without expense to the United States. No claim shall be made against the United States on account of any such removal or alteration.

(B) The permittee shall sign and submit the attached compliance certification form to this office **within 30 days of COMPLETION** of the regulated activity authorized by this permit and any mitigation work required by Special Condition.

(C) The permittee, and their agents, shall take actions to prevent construction materials, including debris, from entering any waterway to become drift or pollution hazards.

REGULATORY BRANCH

SUBJECT: Department of the Army Permit Application File Number NAN-2019-01013-EMI by New Jersey Department of Transportation for Bridge Scour Installation at the NJ Route 18 Bridge over the Raritan River in the City of New Brunswick, Middlesex County, New Jersey

- 3 -

(D) The permittee, and their agents, shall comply with the attached U.S. Coast Guard Bridge Administration General Construction Requirements, Conditions 1 through 22, which are hereby incorporated into the permit authorization by reference, including any other relevant U.S. Coast Guard requirements as per letter #16594, dated June 26, 2019.

8. Please note that this nationwide general permit (NWGP) verification is based on a preliminary jurisdictional determination (JD). A preliminary jurisdictional determination (JD) is not appealable. If you wish, prior to commencement of the authorized work you may request an approved jurisdictional determination (JD), which may be appealed, by contacting the New York District, US Army Corps of Engineers for further instructions. To assist you in this decision and address any questions you may have on the differences between preliminary and approved jurisdictional determinations, please review US Army Corps of Engineers Regulatory Guidance Letter Number 16-01, which can be found at:

<https://usace.contentdm.oclc.org/utills/getfile/collection/p16021coll9/id/1256>

9. This verification is valid until March 18, 2022, unless the nationwide general permits are modified, reissued, or revoked before then. This verification will remain valid until March 18, 2022, if the subject work activity complies with the terms of any subsequent modifications of the nationwide general permits. If the nationwide general permits are suspended, revoked, or modified in such a way that the subject activity would no longer comply with the terms and conditions of a nationwide general permit, and the proposed work activity has commenced, or is under contract to commence, the permittee will have twelve (12) months from the date of such permit action to complete the regulated work.

This authorization is conditional on the permittee's receipt of the required water quality certificate or waiver from the New Jersey Department of Environmental Protection (NJDEP). No work may be accomplished until the required approval or waiver from NJDEP has been obtained.

This authorization is conditional on the permittee's receipt of the required coastal zone management concurrence or waiver from the New Jersey Department of Environmental Protection (NJDEP). No work may be accomplished until the required approval or waiver from NJDEP has been obtained.

10. In order for us to better serve you and others, please complete our Customer Service Survey located at:

SUBJECT: Department of the Army Permit Application File Number NAN-2019-01013-EMI by New Jersey Department of Transportation for Bridge Scour Installation at the NJ Route 18 Bridge over the Raritan River in the City of New Brunswick, Middlesex County, New Jersey

- 4 -

<http://www.nan.usace.army.mil/Missions/Regulatory/CustomerSurvey.aspx>

11. Any inquiries should be directed to our Regulator-of-the-Day at 917-790-8511. Please be sure to have the above eighteen-character file number readily available when you call.



Ronald R. Pinzon
Chief, Eastern Section

Enclosures (3)

1. Dated Permit Drawings
2. Completion Form
3. USCG General Construction Requirements Conditions (1-22)

Copies Furnished:

Malick & Scherer, P.C.
Attn: John Boyce
Shelbourne at Hunterdon
53 Frontage Road, Suite 170
Hampton, New Jersey 08827

USACE FILE: NAN-2019-01013-EM1

1 OF 4

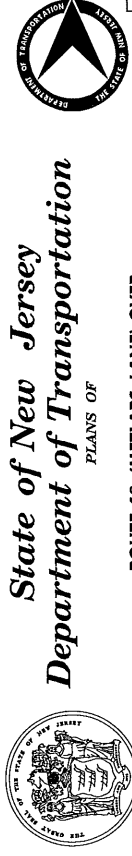

State of New Jersey
Department of Transportation
PLANS OF

ROUTE 18 (METLARS LANE) OVER
RARITAN RIVER BRIDGE
SCOUR COUNTERMEASURES

PISCATAWAY TOWNSHIP
THE CITY OF NEW BRUNSWICK
MIDDLESEX COUNTY
JULY 2019
SCALES AS INDICATED

STATE	FEDERAL PROJECT NO.
N.J.	XXX-XXXX

SHEET#	DESCRIPTION
1	GENERAL NOTES
2	CONSTRUCTION PLAN
3	PROFILES
4	SECTION
5	DETAILS

UTILITIES	
ALDICE CABLEVISION	
MIDDLESEX COUNTY SEWER DEPARTMENT	
CITY OF NEW BRUNSWICK WATER DEPARTMENT	
MIDDLESEX COUNTY UTILITIES AUTHORITY	
MIDDLESEX WATER COMPANY	
VERIZON	
PUBLIC SERVICE ELECTRIC & GAS CO.	
TOWNSHIP OF NORTH BRUNSWICK SEWER DEPARTMENT	

STRUCTURES IN THIS CONTRACT	
NO.	DESCRIPTION
0	STRUCTURE NO. 227-255 RT. 18 OVER RARITAN RIVER

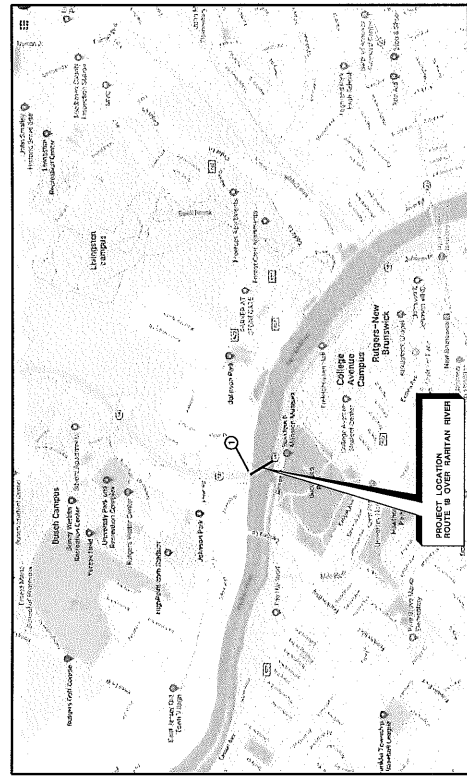

KEY MAP

LENGTH OF PROJECT = 578 LIN. FT. OR 0.11 MILES

2007 STANDARD SPECIFICATIONS FOR ROAD AND BRIDGE CONSTRUCTION TO GOVERN

STANDARD CONSTRUCTION DETAILS -
ROADWAY - TRAFFIC CONTROL
BRIDGE BOOKLET 2016, AND STANDARD
ELECTRICAL DETAILS BOOKLET 2007,
SHALL APPLY TO THIS PROJECT
EXCEPT FOR THOSE DETAILS
CONTAINED HEREIN.

MID-POINT OF PROJECT
LONGITUDE: 74° 27' 28.6" W
LATITUDE: 40° 30' 28.6" N

Submitted by _____ Date _____
Director, Division of Project Management

Approved by _____ Date _____
State Transportation Engineer



CONVEYED MADE TO THESE PLANS
MAY BE DETERMINED BY COMPARISON
DEPARTMENT WITH THOSE FILED AT
THE OFFICE OF CONSULTANT.

MAURICE A. SCHNEIDER, P.E.
ROBERT ZALOWSKI
THE STATE PROFESSIONAL ENGINEER LICENSE NO. 240424200000

Blank's TechnicalDrawings.com - Bridge/Highway/Structures - 2019-07-10 10:00:00 AM - 2019-07-10 10:00:00 AM - 2019-07-10 10:00:00 AM

SEP 06 2019

USACE FILE: NAN-2019-01013-EM1

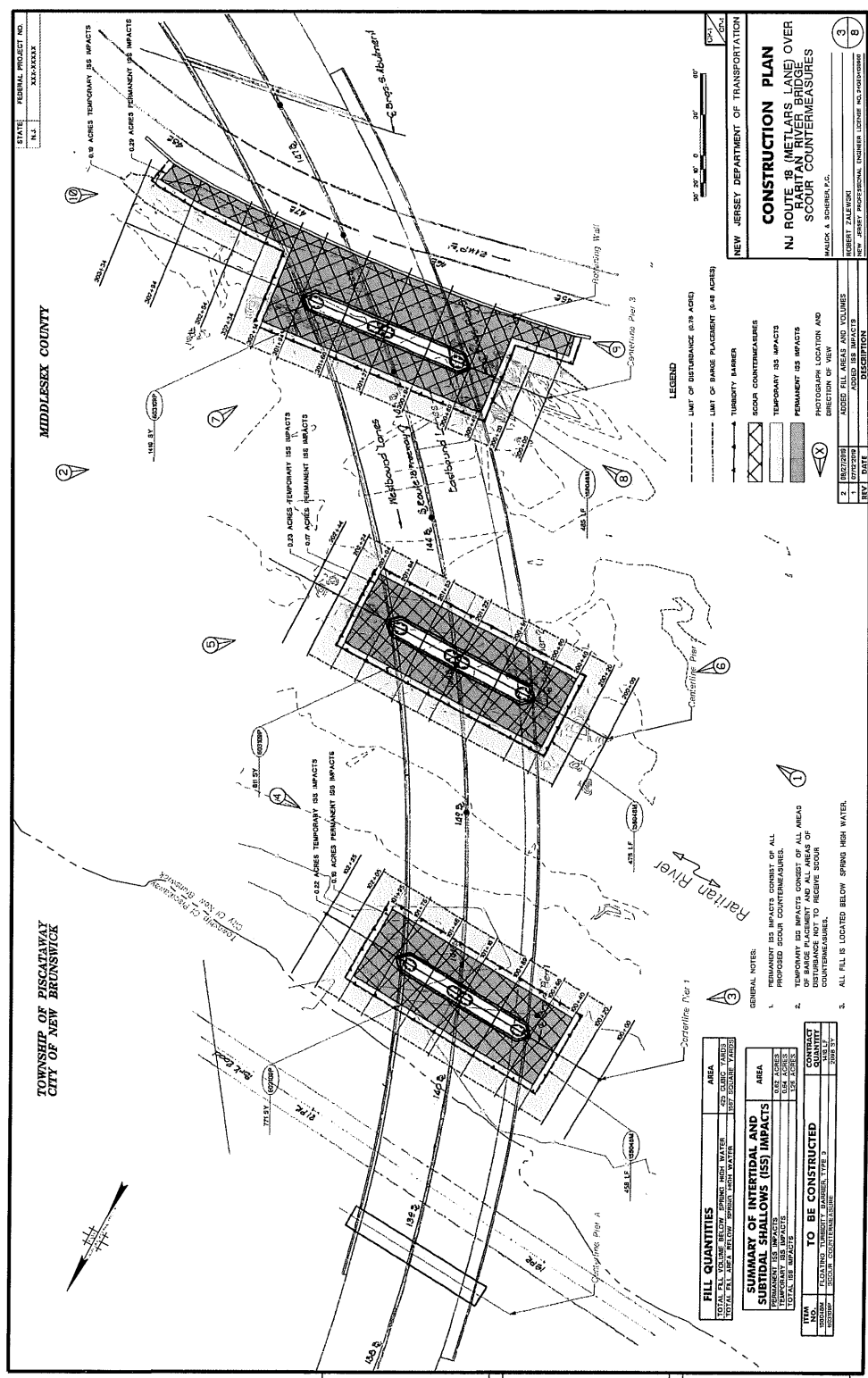

FILL QUANTITIES		AREA	
TOTAL FILL VOLUME BELOW SPRING HIGH WATER	425,000 CUBIC YARDS	TOTAL FILL VOLUME BELOW SPRING HIGH WATER	425,000 CUBIC YARDS
TOTAL FILL VOLUME BELOW NORMAL HIGH WATER	107,000 CUBIC YARDS	TOTAL FILL VOLUME BELOW NORMAL HIGH WATER	107,000 CUBIC YARDS
TOTAL FILL VOLUME BELOW LOW WATER	107,000 CUBIC YARDS	TOTAL FILL VOLUME BELOW LOW WATER	107,000 CUBIC YARDS

SUMMARY OF INTERTIDAL AND SUBTANTIAL SHALLOWS (SS) IMPACTS		AREA	
PERMANENT SS IMPACTS	0.00 ACRES	PERMANENT SS IMPACTS	0.00 ACRES
TEMPORARY SS IMPACTS	144.8 ACRES	TEMPORARY SS IMPACTS	144.8 ACRES
TOTAL SS IMPACTS	144.8 ACRES	TOTAL SS IMPACTS	144.8 ACRES

TO BE CONSTRUCTED		CONTRACT QUANTITY	
TRUCK	100,000 CUBIC YARDS	TRUCK	100,000 CUBIC YARDS
CRUSHED STONE	100,000 CUBIC YARDS	CRUSHED STONE	100,000 CUBIC YARDS
GRAVEL	100,000 CUBIC YARDS	GRAVEL	100,000 CUBIC YARDS
AGGREGATE	100,000 CUBIC YARDS	AGGREGATE	100,000 CUBIC YARDS

GENERAL NOTES:

- PERMANENT SS IMPACTS CONSIST OF ALL PROPOSED SCOUR CONTOURMEASURES.
- ALL PERMANENT SS IMPACTS ARE AREAS OF BARRE PLACEMENT AND ALL AREAS OF DISTURBANCE NOT TO RECEIVE SCOUR CONTOURMEASURES.
- ALL FILL IS LOCATED BELOW SPRING HIGH WATER.

LEGEND

- LIMIT OF DISTURBANCE (8.75 ACRES)
- TURBIDITY MARKER
- SCOUR CONTOURMEASURES
- TEMPORARY SS IMPACTS
- PERMANENT SS IMPACTS
- PHOTOGRAPH LOCATION AND DIRECTION OF VIEW

NEW JERSEY DEPARTMENT OF TRANSPORTATION
CONSTRUCTION PLAN
 NJ ROUTE 18 (METLARS LANE) OVER
 HARTMAN RIVER BRIDGE
 SCOUR COUNTERMEASURES
 MALICK & SOHRER, P.C.
 ROBERT ZALEWSKI
 NEW JERSEY PROFESSIONAL ENGINEER LICENSE NO. F040000000

REV.	DATE	DESCRIPTION
2	08/20/19	ADDED FILL AREA AND VOLUMES
3	08/20/19	ADDED TURBIDITY MARKER
3	08/20/19	ADDED PHOTOGRAPH LOCATION AND DIRECTION OF VIEW

SEP 06 2019

USACE FILE: NAN-2019-01013-EMI

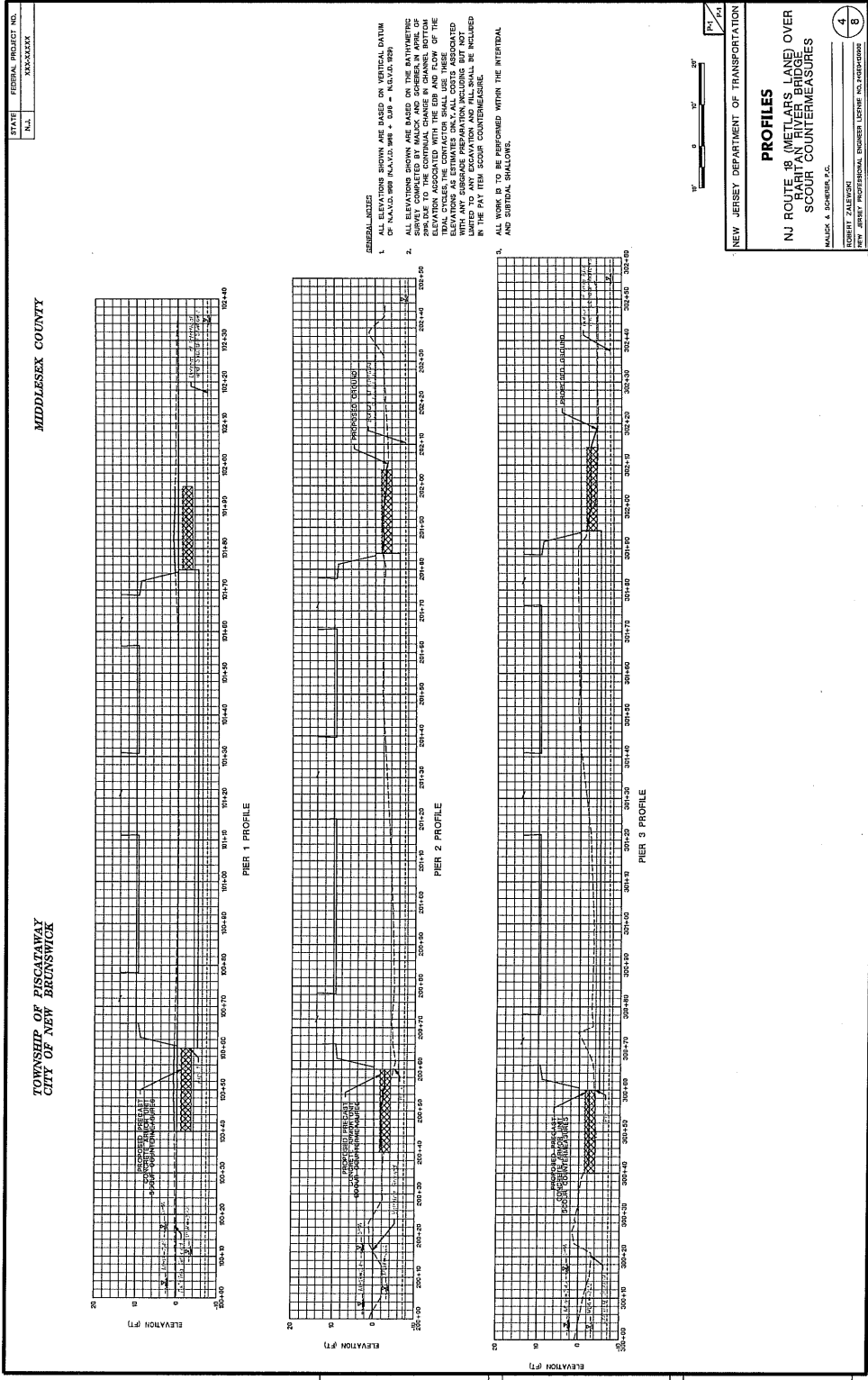

STATE: FEDERAL PROJECT NO. N.J. XXXXXXX

MIDDLESEX COUNTY

TOWNSHIP OF FISCATAWAY
CITY OF NEW BRUNSWICK

GENERAL NOTES

1. ALL ELEVATIONS SHOWN ARE BASED ON VERTICAL DATUM OF MEANS AND SHALL BE USED AS SHOWN UNLESS OTHERWISE NOTED.
2. THE CONTRACTOR SHALL BE RESPONSIBLE FOR VERIFYING THE ACCURACY OF THE SURVEY COMPLETED BY MALIK & SCHERER, P.C. IN APRIL OF 2018. DUE TO THE CONTINUAL CHANGE IN CHANNEL BOTTOM OF THE RIVER, THE CONTRACTOR SHALL USE THESE ELEVATIONS AS ESTIMATES ONLY. ALL CORRECTIONS TO THE ORIGINAL SURVEY DATA SHALL BE LIMITED TO ANY EXCAVATION AND FILL SHALL BE INCLUDED IN THE PAY ITEM SCOUR COUNTERMEASURE.

ALL WORK IS TO BE PERFORMED WITHIN THE INTERTIDAL AND SUBTIDAL SHALLOWS.

NEW JERSEY DEPARTMENT OF TRANSPORTATION

PROFILES

NJ ROUTE 18 (METLARS LANE) OVER
HARTMAN RIVER BRIDGE
SCOUR COUNTERMEASURES

MALIK & SCHERER, P.C.
ROBERT ZALEWSKI
NEW JERSEY PROFESSIONAL ENGINEER LICENSE NO. 480000000

4
8

Sheet 1 of 2. Profile 1 of 3. Stationing 80+00 to 102+40. Elevation 95 to 125 feet. Date: 09/06/2019. Scale: 1"=20'. Project: NJ Route 18 Scour Countermeasures.

SEP 06 2019

USACE FILE: NAN-2019-01013-EMI

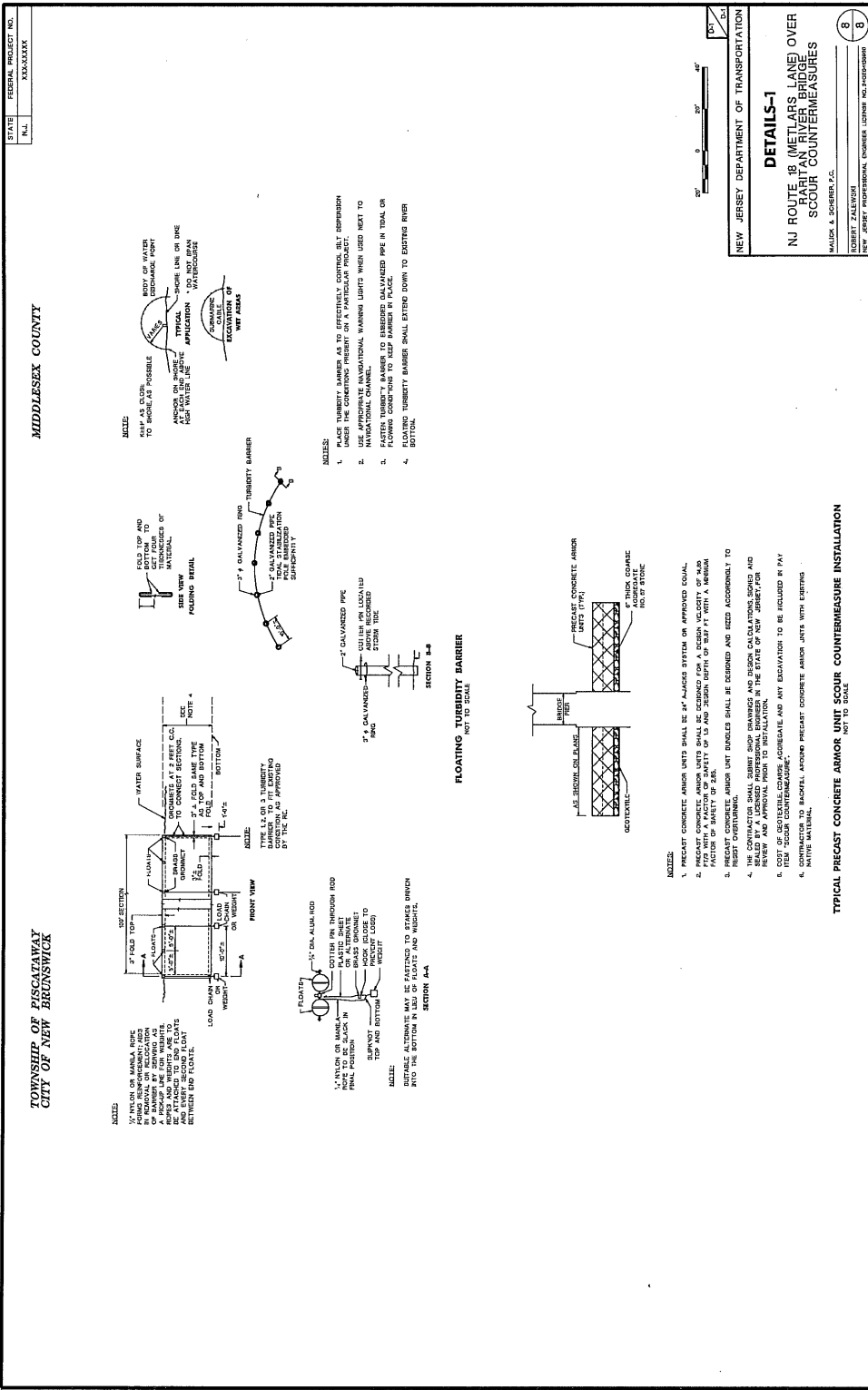

SEP 06 2019

4064

MALICK & SOBERER, P.C., HARTON NEW JERSEY

U.S. Department of
Homeland Security

United States
Coast Guard



Commander
First Coast Guard District

Battery Park Bldg.
One South Street
New York, NY 10004-1466
Staff Symbol: (dpb)
Phone: (212) 514-4336

16594
June 17, 2019

New Jersey DOT
Mr. Brendan Brock
Environmental Scientist 3
P. O. Box 600
Trenton, NJ 08625-0600

Dear Mr. Brock,

This is in response to your letter dated May 31, 2019 regarding scour countermeasures at the Route 18 Bridge across Raritan River, mile 14.2, Middlesex County, NJ.

After reviewing the preliminary scour countermeasures plans, this office determined that this work does not require formal Coast Guard Bridge Permit as long as the scour materials do not reduce the existing channel depth.

Although this project will not require a formal bridge permit, we are providing the attached general construction requirements (enclosure 1) that apply for work on, over, near, or affecting the waterway and that must be complied with. These stipulations are based on the facts presently before us and additional requirements may be imposed if the contractor submits an approach or action not anticipated by this office. **Upon receipt and review of plans submitted pursuant paragraph 4 of enclosure (1), authorization to work over the waterway will be issued by this office.**

Please forward to this office, all permits/concurrence received from the Army Corps of Engineers and any other regulatory agency regarding the project.

If you have any questions, please contact me at the above number.

Sincerely,

A handwritten signature in cursive script that reads "Judy Leung-Yee".

J. Leung-Yee
Bridge Management Specialist
U.S. Coast Guard
By direction

E-Copy: Commander – Sector New York WWM

Enclosure (1): General Construction Requirements

U.S. Coast Guard Bridge Administration

GENERAL CONSTRUCTION REQUIREMENTS

1. All bridge closures, or bridge operating schedule changes, must be requested in writing, 90-days in advance, from the First Coast Guard District Bridge Branch Office. No channel restrictions, or vertical clearance reductions may be made without written approval from the above office.
2. Waterway closures/restrictions, barge placement or safety zones must also be requested a **minimum** of 90-days in advance. Please contact USCG Sector New York, 212 Coast Guard Drive, Staten Island, NY 10305-5005. Ph: (718) 354-4195/2353.
3. All submissions to the Coast Guard for review and approval must first be approved by the owner of the bridge or their authorized agent. All submission of plans, scope of work, and schedules of operation must be sent to the First Coast Guard District, Bridge Branch Office.
4. At least 30-days prior to commencement of any work, we must have for our review and approval, a copy of the construction plans, contractor schedule, preferably depicted in a time line graphic format, and the contractor's daily hours of operation. The construction plan package must show the following: **(1)** a plan of the entire waterway area in the vicinity of the project. **(2)** The location of work barges during working and off-hours. **(3)** In addition, a drawing must be included, if applicable, depicting any scaffolding or containment used indicating the location and the total vertical or horizontal channel reduction. All vertical clearance reductions below low steel or concrete under the bridge as a result of the use of scaffolding must be clearly detailed on the drawings shown in total feet. **(4)** Emergency 24-hour telephone numbers for all responsible individuals for this project must be submitted to this office before any phase of construction begins in case of an emergency situation during off-hours.
5. Scaffolding used under ANY span of the bridge must be lighted with constant burning red lights every 50 feet and on all corners. The placement of scaffolding must not interfere with the ability of a moveable bridge to open for vessel traffic. Moveable bridges must continue to operate according to their normal schedule unless special drawbridge operation regulation changes have been requested. Warning signs must be posted on both sides of the bridge, visible for a 1-mile range, to warn mariners of the vertical clearance reduction. The signs shall face upstream and downstream so as to draw the mariner's attention to the fact that the clearance has been reduced.
6. All barges placed in the waterway must be lighted with constant burning white lights on all four corners of the barge. The contractor is required to comply with all provisions of the Navigation Rules International-Inland, regarding the use of work barges or floating equipment in the waterway. www.navcen.uscg.gov .
7. Placement of construction barges in the navigable channel shall be done so as to provide a minimum horizontal clearance reduction. Only one navigation channel of a swing bridge may be blocked by work equipment at anytime. Barges must be moved out of the navigable channel after working hours unless approved in writing by the USCG.

NY & NJ

8. Barges held in place by anchor lines must be marked by anchor buoys, which should be lighted.
9. The vertical and horizontal clearances through the navigable channel of the completed structure (as-built clearances) shall be certified in writing to this office by a responsible official of the permittee, a licensed surveyor or a registered professional engineer upon completion of bridge work. As built clearances consist of: vertical clearance in the navigational channel measured from mean high and mean low water to the lowest point of the superstructure; horizontal clearance through the navigational channel between piers or fenders measured normal to the axis of the channel. Documentation shall state the horizontal and vertical datum (e.g., NAVD88) used for all measurements. Please contact this office if there are questions regarding the required clearance data for specific bridge types, i.e. fixed or movable.
10. The on-scene contractor must have a VHF-FM marine radio set to the bridge communication channels 16/13 or the designated channel for the bridge. Additional marine radios monitoring the above channels must also be maintained at the main control of any floating equipment or barges on station.
11. Preventive measures must be taken to prevent any hot work, debris, or construction material from entering the waterway. This includes sandblasting material, paint, and any concrete work by-products. Welding and burning must cease upon approach of a vessel and shall not start again until the vessel has passed the bridge.
12. The project manager must contact the Coast Guard Sector New York-VTS via marine radio before commencement of any and after completion of any Hot Work. A cell phone back-up may be used to contact the above Coast Guard Unit at (718) 354-4088.
13. If permanent bridge navigational lighting cannot be maintained operational during any phase of this project, temporary battery/power lights must be installed at the same locations. These temporary lights must be visible for a distance of **2,000 yards on 90% of the nights of the year**. Generally, a lamp of **(50 candela)** will meet these requirements. Plans for temporary lighting shall be submitted to this office for written approval. Deviations from the approved temporary lighting shall be permitted only upon written authorization from this office.
14. All newly constructed bridge piers, or those in the process of demolition, must be lighted with either red or white flashing (60 flashes per minute) lights. All cofferdams used during construction must also be lighted with red or white flashing (60 flashes per minute) on all four corners.
15. Bridge protective fenders shall not be constructed or rebuilt with any metal surfaces on the rubbing face of the fender system. All bolts, spikes, or other metal fastening devices must be countersunk. Metal splicing plates, if used, shall be mounted on back of outer wales.
16. All piles including those previously damaged or broken that are not being used in the new or repaired fender shall be extracted rather than cut off at the mud line. Upon completion of all fender repairs a bottom sweep is required to determine if any piles or debris are present in the waterway. A wire-drag sweep or side-scan sonar is the preferred method.
17. It is the owners' responsibility to ensure that channel depths are not affected by this work.

NY & NJ

Any material, machinery or equipment lost, dumped, thrown into, or otherwise entering the waterway must be removed immediately. If immediate removal is impractical and the object entering the waterway could possibly obstruct or hazard navigation, the object must be marked immediately to protect navigation and the Coast Guard shall be notified as soon as possible. Such notification shall give the location and type of obstruction and the navigational markings installed.

18. Spillage of oil and hazardous substances is specifically prohibited by Section 311 of the Clean Water Act, as amended. Measures including properly maintaining construction equipment, designating fuel/hazardous substances handling areas to allow spills to be contained before reaching the waterway, instructing personnel not to dispose of oil/hazardous substances into drains or into the waterway directly, and other necessary procedures should be implemented to prevent spillage. If oil/hazardous substances are spilled into the waterway in spite of such planning, the U.S. Coast Guard is to be notified immediately at 800-424-8802. An adequate supply of absorbent material should be readily accessible to soak up any possible spillage pending Coast Guard arrival. The use of chemical dispersing agents and emulsifiers is not authorized without prior, specific, federal approval.
19. The bridge owner/contractor shall provide any and all necessary equipment and personnel to determine the presence of any "suspected" obstructions in the waterway at any time either during or following the completion of bridge construction or demolition operations.
20. The owner or registered professional engineer shall certify that the waterway depths have not been impaired and that the waterway is clear of materials or debris resulting from bridge construction or demolition.
21. This approval may be revoked and/or civil penalties imposed for failure to ensure that the above listed stipulations are adhered to or if work is determined to hazard or impair navigation.
22. This bridge work authorization does not relieve the project proponent of the responsibility to comply with applicable state, local or other federal requirements for this project.

NATIONWIDE GENERAL PERMIT
COMPLIANCE CERTIFICATION
AND REPORT FORM

Permit File Number: NAN-2019-01013-EMI

Permittee: New Jersey Department of Transportation

Location: NJ Route 18 Bridge over Raritan River (NJDOT #1237-155), City of New Brunswick, Middlesex County, New Jersey

Date Permit Letter Issued: SEP 06 2019

Within 30 days of the completion of the activity authorized by this nationwide general permit and any mitigation required in the verification letter, please sign this certification and return it to the address at the bottom of this form.

Please note that your permitted activity is subject to a compliance inspection by a U.S. Army Corps of Engineers representative. If you fail to comply with the permit's terms and conditions you are subject to permit suspension, modification or revocation.

I hereby certify that the work authorized by the above referenced nationwide general permit has been completed in accordance with the terms and conditions of said permit, and required mitigation was completed in accordance with the permit conditions.

Signature of Permittee Date

**FOLD THIS FORM INTO THIRDS, WITH THE BOTTOM THIRD FACING OUTWARD.
TAPE IT TOGETHER AND MAIL TO THE ADDRESS BELOW OR FAX (212) 264-4260.**

PLACE
STAMP
HERE

DEPARTMENT OF THE ARMY
NEW YORK DISTRICT CORPS OF ENGINEERS
JACOB K. JAVITS FEDERAL BUILDING
ATTN: CENAN-OP-RE
NEW YORK, NEW YORK 10278-0090